

Pull-Thru Rivet

All Steel Double Csk. Head

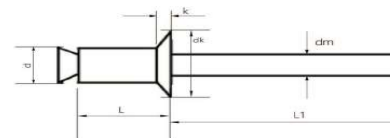

Features	Applications
<ul style="list-style-type: none"> * Pull-Thru rivet are unique double countersunk blind rivets * Pull-Thru rivet designed to set surface flush on both sides of an application * It is suitable for sheet metal products with limited space, and there must be sink holes on both sides of the products that require riveting. * Pull-thru rivet is that after the riveting is completed, there is no nail head falling off, and the two riveting surfaces of the product are relatively flat. 	<ul style="list-style-type: none"> • Electronics industry • Many low-clearance industrial applications.

	Material	Finish	Head
Body:	Carbon Steel	Zinc Plated	Countersunk (120°)
Mandrel:	Carbon Steel	Zinc Plated	

Product Code SKU	Size		Body Length	Head Height	Head Dia. (Max)	Mandrel Reveal (Ref)	Hole Size	Grip Range	Tensile	Shear
	d (mm)	Inch	L (mm)	K (mm)	dk (mm)	L1 (mm)	(mm)	(mm)	N	N
PTSSC3025	3.0	1/8"	2.5	1	5.5	27	3.3-3.4	1.5 - 2.0	800	700
PTSSC3030	3.0	1/8"	2.8	1	5.5	27	3.3-3.4	2.0 - 2.5	800	700
PTSSC3035	3.0	1/8"	3.3	1	5.5	27	3.3-3.4	2.5 - 3.0	800	700
PTSSC3040	3.0	1/8"	3.8	1	5.5	27	3.3-3.4	3.0 - 3.5	800	700
PTSSC3045	3.0	1/8"	4.3	1	5.5	27	3.3-3.4	3.5 - 4.0	800	700
PTSSC3050	3.0	1/8"	4.8	1	5.5	27	3.3-3.4	4.0 - 4.5	800	700
PTSSC3055	3.0	1/8"	5.3	1	5.5	27	3.3-3.4	4.5 - 5.0	800	700
PTSSC3060	3.0	1/8"	5.8	1	5.5	27	3.3-3.4	5.0 - 5.5	800	700
PTSSC3065	3.0	1/8"	6.3	1	5.5	27	3.3-3.4	5.5 - 6.0	800	700

Set Up:



1300 532 803
sales@tower-tr.com.au
www.tower-tr.com.au

Disclaimer: every effort has been made to ensure the information provided in this document is accurate and up to date. However, Tower Fastening System does not guarantee or warrant the accuracy, completeness, or currency of the information provided.

