

Open Blind Rivet

Blind Rivets are now capable in every industrial field to replace Welding, Tapping Screws or Bolts & Nuts and to fasten materials speedy and securely from one side of the work by using an exclusive fastening tool.

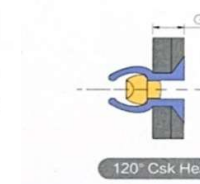
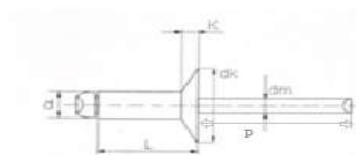

Advantage:	Applications
<ul style="list-style-type: none"> * Strong but lower cost fastener * Available in variety of materials and ideal for wide range of applications * Painted colour finished available to match surrounding 	<ul style="list-style-type: none"> • Office furniture • Automotive • Building • Construction • Leather production

	Material	Finish	Head
Body:	Stainless (A2 304)	Natural Polish	120° Countersunk
Mandrel:	Stainless (A2 304)	Natural Polish	

Product Code SKU	Size		Body Length	Head Height	Head Dia. (Max)	Mandrel (Ref)	Hole Size	Grip Range	Tensile	Shear
	D (mm)	Inch	L (±1)mm	K (mm)	dK (mm)	P (mm)	(mm)	(mm)	N	N
KKC4-2	3.2	1/8"	6	1.3	6.3	27	3.3-3.4	1.0-3.5	2500	1900
KKC4-3	3.2	1/8"	8	1.3	6.3	27	3.3-3.4	3.5-5.0	2500	1900
KKC4-4	3.2	1/8"	10	1.3	6.3	27	3.3-3.4	5.0-7.0	2500	1900
KKC4-6	3.2	1/8"	14	1.3	6.3	27	3.3-3.4	7.0-11.0	2500	1900
KKC5-2	4.0	5/32"	8	1.7	7.5	27	4.1-4.2	3.0-5.0	3500	2700
KKC5-3	4.0	5/32"	10	1.7	7.5	27	4.1-4.2	4.0-6.5	3500	2700
KKC5-4	4.0	5/32"	12	1.7	7.5	27	4.1-4.2	6.0-8.5	3500	2700
KKC5-5	4.0	5/32"	14	1.7	7.5	27	4.1-4.2	8.0-12.5	3500	2700
KKC6-2	4.8	3/16"	8	2.0	9.5	27	4.9-5.0	1.0-4.0	5000	4000
KKC6-3	4.8	3/16"	10	2.0	9.5	27	4.9-5.0	4.0-6.0	5000	4000
KKC6-4	4.8	3/16"	12	2.0	9.5	27	4.9-5.0	6.0-8.0	5000	4000
KKC6-5	4.8	3/16"	14	2.0	9.5	27	4.9-5.0	8.0-10.0	5000	4000
KKC6-8	4.8	3/16"	18	2.0	9.5	27	4.9-5.0	10.0-14.0	5000	4000
KKC6-10	4.8	3/16"	20	2.0	9.5	27	4.9-5.0	12.0-16.0	5000	4000
KKC6-12	4.8	3/16"	25	2.0	9.5	27	4.9-5.0	16.0-21.0	5000	4000

1300 532 803
sales@tower-tr.com.au
www.tower-tr.com.au

Disclaimer: every effort has been made to ensure the information provided in this document is accurate and up to date. However, Tower Fastening System does not guarantee or warrant the accuracy, completeness, or currency of the information provided.

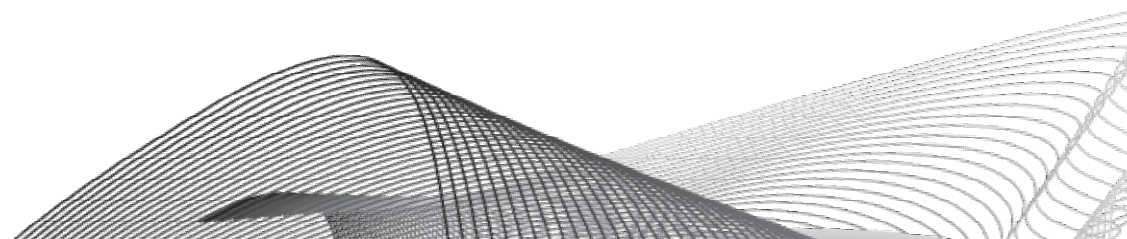

Open Blind Rivet

Blind Rivets are now capable in every industrial field to replace Welding, Tapping Screws or Bolts & Nuts and to fasten materials speedy and securely from one side of the work by using an exclusive fastening tool.

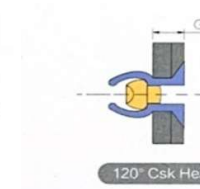
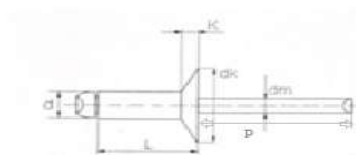

Advantage:	Applications
<ul style="list-style-type: none"> * Strong but lower cost fastener * Available in variety of materials and ideal for wide range of applications * Painted colour finished available to match surrounding 	<ul style="list-style-type: none"> • Office furniture • Automotive • Building • Construction • Leather production

	Material	Finish	Head
Body:	Stainless (A2 304)	Natural Polish	120° Countersunk
Mandrel:	Stainless (A2 304)	Natural Polish	

Product Code SKU	Size		Body Length	Head Height	Head Dia. (Max)		Mandrel (Ref)	Hole Size	Grip Range	Tensile	Shear
	D (mm)	Inch			K (mm)	dK (mm)					
KKC8-8	6.4	1/4"	20	2.7	12.5		27	6.5-6.6	10.0-14.0	9300	7500
KKC8-10	6.4	1/4"	23	2.7	12.5		27	6.5-6.6	12.0-16.0	9300	7500
KKC8-12	6.4	1/4"	25	2.7	12.5		27	6.5-6.6	14.0-18.0	9300	7500

1300 532 803
sales@tower-tr.com.au
www.tower-tr.com.au

Disclaimer: every effort has been made to ensure the information provided in this document is accurate and up to date. However, Tower Fastening System does not guarantee or warrant the accuracy, completeness, or currency of the information provided.

