

Anlock Rivet (Mega Lock)

Anlock Blind Rivets In-Bolt with a multi-grip clamping range and a high tensile and shear strength provides a high resistance to vibrations and a good watertight performance.

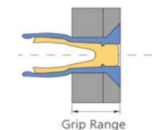
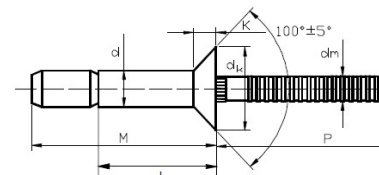

Advantage:	Applications
<ul style="list-style-type: none"> * High shear and tensile strength * Superior holding power (Clamp up) * Fastens over wide grip range * Locking feature prevents loosening of mandrel from vibration 	<ul style="list-style-type: none"> • Automotive industry • Truck building • Containers • Construction work • Coach work

	Material	Finish	Head
Body: Mandrel:	Carbon Steel Carbon Steel	Zinc Plated Zinc Plated	Countersunk

Product Code SKU	Size		Body Length	Head Height	Head Dia. (Max)	Mandrel (Ref)	Hole Size	Grip Range	Tensile	Shear
	d (mm)	Inch	L (±1)mm	K (mm)	dk (mm)	P (mm)	(mm)	(mm)	N	N
ANSSC6-6	4.8	3/16"	12	2.1	9.2	27	4.9-5.1	3.2-8.4	4000	5400
ANSSC6-8	4.8	3/16"	16	2.1	9.2	27	4.9-5.1	3.2-12.7	4000	5400
ANSSC8-8	6.4	1/4"	16	2.3	11.4	27	6.7-6.9	4.3-12.1	8200	10500
ANSSC8-12	6.4	1/4"	23	2.3	11.4	27	6.7-6.9	4.3-18.4	8200	10500
ANSSC12-12	9.8	3/8"	26	3.7	16.5	27	10.0-10.4	6.1-19.0	15500	25000

1300 532 803
sales@tower-tr.com.au
www.tower-tr.com.au

Disclaimer: every effort has been made to ensure the information provided in this document is accurate and up to date. However, Tower Fastening System does not guarantee or warrant the accuracy, completeness, or currency of the information provided.

