

## Anlock Rivet (Mega Lock)

Anlock Blind Rivets In-Bolt with a multi-grip clamping range and a high tensile and shear strength provides a high resistance to vibrations and a good watertight performance.

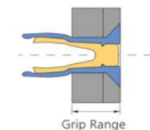
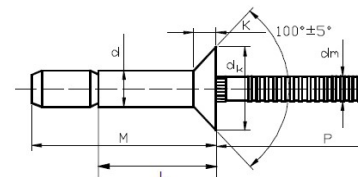

Advantage:	Applications
<ul style="list-style-type: none"> <li>* High shear and tensile strength</li> <li>* Superior holding power (Clamp up)</li> <li>* Fastens over wide grip range</li> <li>* Locking feature prevents loosening of mandrel from vibration</li> </ul>	<ul style="list-style-type: none"> <li>• Automotive industry</li> <li>• Truck building</li> <li>• Containers</li> <li>• Construction work</li> <li>• Coach work</li> </ul>

	Material	Finish	Head
<b>Body:</b>	Aluminum	Natural Polish	Countersunk
<b>Mandrel:</b>	Aluminum	Natural Polish	

Product Code SKU	Size		Body Length	Head Height	Head Dia. (Max)	Mandrel (Ref)	Hole Size	Grip Range	Tensile	Shear
	d (mm)	Inch	L (±1)mm	K (mm)	dk (mm)	P (mm)	(mm)	(mm)	N	N
ANAAC6-6	4.8	3/16"	12	2.1	9.2	27	4.9-5.1	3.2-8.4	1900	2300
ANAAC6-8	4.8	3/16"	16	2.1	9.2	27	4.9-5.1	7.7-12.7	1900	2300
ANAAC8-8	6.4	1/4"	16	2.3	11.4	27	6.7-6.9	4.3-12.1	3400	5300
ANAAC8-12	6.4	1/4"	23	2.3	11.4	27	6.7-6.9	10.5-18.4	3400	5300

1300 532 803  
[sales@tower-tr.com.au](mailto:sales@tower-tr.com.au)  
[www.tower-tr.com.au](http://www.tower-tr.com.au)

Disclaimer: every effort has been made to ensure the information provided in this document is accurate and up to date. However, Tower Fastening System does not guarantee or warrant the accuracy, completeness, or currency of the information provided.

